

Nominal Size DN	A	R	L	T	Ordering Code
10	13	26	26	1.5	010000-200-D* **
15	19	35	35	1.5	015000-200-D* **
20	23	40	40	1.5	020000-200-D* **
25	29	50	50	1.5	025000-200-D* **
32	35	55	55	1.5	032000-200-D* **
40	41	60	60	1.5	040000-200-D* **
50	53	70	70	1.5	050000-200-D* **
65	70	80	80	2.0	065000-200-D* **
80	85	90	90	2.0	080000-200-D* **
100	104	100	100	2.0	100000-200-D* **
125	129	187.5	187.5	2.0	125000-200-D* **
150	154	225	225	2.0	150000-200-D* **
200	204	300	300	2.0	200000-200-D* **

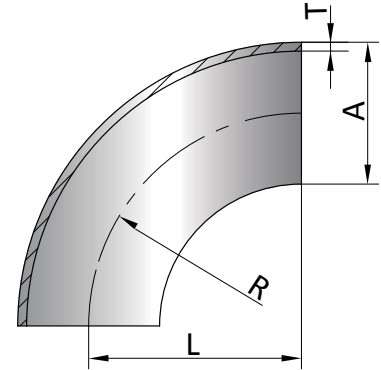

* The first digit referse to material guide, according to Table 1
 ** The last digit referse to surface quality, according to Table 2

Table1

Material Guide	
1.4301 (304)	1
1.4307 (304L)	2
1.4401 (316)	3
1.4404 (316L)	4

Table 2

Inside Surface	Outside Surface	Ordering Code
No finish requirement	No finish requirement	u
MP* 30μ-in 0.80μm	No finish requirement	0
MP* 30μ-in 0.80μm	MP* 30μ-in 0.80μm	3
MP* 20μ-in 0.51μm	MP* 30μ-in 0.80μm	4
MP* 12μ-in 0.30μm	MP* 30μ-in 0.80μm	7
MP* 9μ-in 0.23μm	MP* 30μ-in 0.80μm	8
Mirror	MP* 30μ-in 0.80μm	9

*MP: Mechanically Polished

Ordering Example

Description	Nominal Size DN	Ordering Code
Type 200	25	025000-200-D63*

*Material and Surface are including to the ordering code

Fittings

Bend 90 Degrees

SEALING SYSTEMS

Nominal Size DN	A	R	L	T	Ordering Code
10	12	26	26	1.5	010000-201-D* **
15	18	35	35	1.5	015000-201-D* **
20	22	40	40	1.5	020000-201-D* **
25	28	50	50	1.5	025000-201-D* **
32	34	55	55	1.5	032000-201-D* **
40	40	60	60	1.5	040000-201-D* **
50	52	70	70	1.5	050000-201-D* **

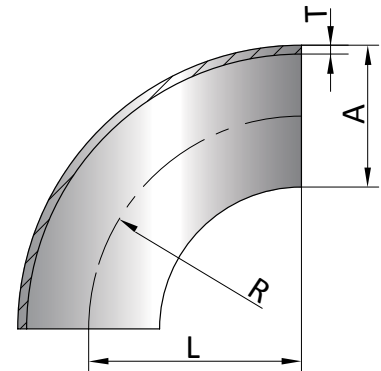

* The first digit referse to material guide, according to Table 1
 ** The last digit referse to surface quality, according to Table 2

Table1

Material Guide	
1.4301 (304)	1
1.4307 (304L)	2
1.4401 (316)	3
1.4404 (316L)	4

Table 2

Inside Surface	Outside Surface	Ordering Code
No finish requirement	No finish requirement	u
MP* 30μ-in 0.80μm	No finish requirement	0
MP* 30μ-in 0.80μm	MP* 30μ-in 0.80μm	3
MP* 20μ-in 0.51μm	MP* 30μ-in 0.80μm	4
MP* 12μ-in 0.30μm	MP* 30μ-in 0.80μm	7
MP* 9μ-in 0.23μm	MP* 30μ-in 0.80μm	8
Mirror	MP* 30μ-in 0.80μm	9

*MP: Mechanically Polished

Ordering Example

Description	Nominal Size DN	Ordering Code
Type 201	25	025000-201-D63*

*Material and Surface are including to the ordering code

Fittings

Bend 90 Degrees

SEALING SYSTEMS

Nominal Size DN	A	R	L	T	Ordering Code
10	13	26	38	1.5	010000-250-D* **
15	19	35	47	1.5	015000-250-D* **
20	23	40	52	1.5	020000-250-D* **
25	29	50	70	1.5	025000-250-D* **
32	35	55	78	1.5	032000-250-D* **
40	41	60	85	1.5	040000-250-D* **
50	53	70	97	1.5	050000-250-D* **
65	70	80	110	2.0	065000-250-D* **
80	85	90	118	2.0	080000-250-D* **
100	104	100	140	2.0	100000-250-D* **
125	129	187.5	245	2.0	125000-250-D* **

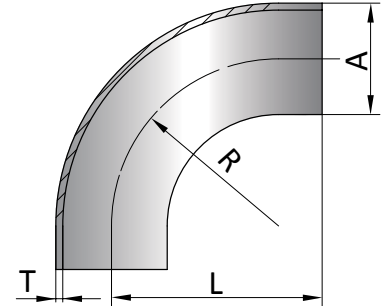

* The first digit referse to material guide, according to Table 1
 ** The last digit referse to surface quality, according to Table 2

Table1

Material Guide	
1.4301 (304)	1
1.4307 (304L)	2
1.4401 (316)	3
1.4404 (316L)	4

Table 2

Inside Surface	Outside Surface	Ordering Code
No finish requirement	No finish requirement	u
MP* 30μ-in 0.80μm	No finish requirement	0
MP* 30μ-in 0.80μm	MP* 30μ-in 0.80μm	3
MP* 20μ-in 0.51μm	MP* 30μ-in 0.80μm	4
MP* 12μ-in 0.30μm	MP* 30μ-in 0.80μm	7
MP* 9μ-in 0.23μm	MP* 30μ-in 0.80μm	8
Mirror	MP* 30μ-in 0.80μm	9

*MP: Mechanically Polished

Ordering Example

Description	Nomimal Size DN	Ordering Code
Type 250	25	025000-250-D63*

*Material and Surface are including to the ordering code

Fittings

Bend 90 Degrees

SEALING SYSTEMS

Nominal Size DN	A	R	L	T	Ordering Code
10	12	26	38	1.5	010000-255-D* **
15	18	35	47	1.5	015000-255-D* **
20	22	40	52	1.5	020000-255-D* **
25	28	50	70	1.5	025000-255-D* **
32	34	55	78	1.5	032000-255-D* **
40	40	60	85	1.5	040000-255-D* **
50	52	70	97	1.5	050000-255-D* **

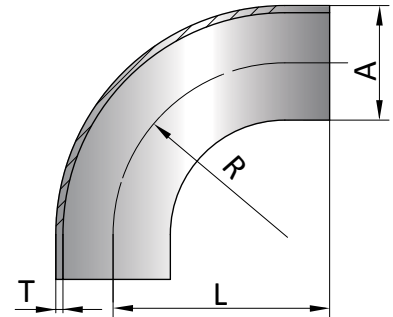

* The first digit refer to material guide, according to Table 1

** The last digit refer to surface quality, according to Table 2

Table 1

Material Guide	
1.4301 (304)	1
1.4307 (304L)	2
1.4401 (316)	3
1.4404 (316L)	4

Table 2

Inside Surface	Outside Surface	Ordering Code
No finish requirement	No finish requirement	u
MP* 30μ-in 0.80μm	No finish requirement	0
MP* 30μ-in 0.80μm	MP* 30μ-in 0.80μm	3
MP* 20μ-in 0.51μm	MP* 30μ-in 0.80μm	4
MP* 12μ-in 0.30μm	MP* 30μ-in 0.80μm	7
MP* 9μ-in 0.23μm	MP* 30μ-in 0.80μm	8
Mirror	MP* 30μ-in 0.80μm	9

*MP: Mechanically Polished

Ordering Example

Description	Nominal Size DN	Ordering Code
Type 255	25	025000-255-D63*

*Material and Surface are including to the ordering code

Nomimal Size DN	A	R	L	T	Ordering Code
8	13.5	20	20	1.6	008000-200-G* **
10	17.2	28	28	1.6	010000-200-G* **
15	21.3	30	30	1.6	015000-200-G* **
20	26.9	28(min)	28(min)	1.6	020000-200-G* **
25	33.7	38	38	2.0	025000-200-G* **
32	42.4	47.5	47.5	2.0	032000-200-G* **
40	48.3	57	57	2.0	040000-200-G* **
50	60.3	76	76	2.0	050000-200-G* **
65	76.1	95	95	2.0	065000-200-G* **
80	88.9	114.5	114.5	2.3	080000-200-G* **
100	114.3	152.5	207.5	2.3	100000-200-G* **

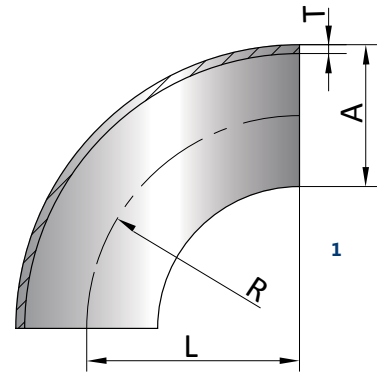

* The first refere to material guide, according to Table
** The last digit refere to surface quality, according to Table 2

Table1

Material Guide	
1.4301 (304)	3
1.4307 (304L)	4
1.4401 (316)	5
1.4404 (316L)	6

Table 2

Inside Surface	Outside Surface	Ordering Code
No finish requirement	No finish requirement	u
MP* 30μ-in 0.80μm	No finish requirement	0
MP* 30μ-in 0.80μm	MP* 30μ-in 0.80μm	3
MP* 20μ-in 0.51μm	MP* 30μ-in 0.80μm	4
MP* 12μ-in 0.30μm	MP* 30μ-in 0.80μm	7
MP* 9μ-in 0.23μm	MP* 30μ-in 0.80μm	8
Mirror	MP* 30μ-in 0.80μm	9

*MP: Mechanically Polished

Ordering Example

Description	Nomimal Size DN	Ordering Code
Type 200	25	025000-200-G64

*Material and Surface are including to the ordering code

Nomimal Size DN	A	R	L	T	Ordering Code
6	10.2	20	45	1.6	006000-250-G* **
8	13.5	20	45	1.6	008000-250-G* **
10	17.2	28	53	1.6	010000-250-G* **
15	21.3	30	55	1.6	015000-250-G* **
20	26.9	28.5	68.5	1.6	020000-250-G* **
25	33.7	38	78	2.0	025000-250-G* **
32	42.4	47.5	87.5	2.0	032000-250-G* **
40	48.3	57	97	2.0	040000-250-G* **
50	60.3	76	116	2.0	050000-250-G* **
65	76.1	95	150	2.0	065000-250-G* **
80	88.9	114.5	169.5	2.3	080000-250-G* **
100	114.3	152.5	207.5	2.3	100000-250-G* **
125	139.7	190.5	245.5	2.6	125000-250-G* **
150	168.3	228.5	283.5	2.6	150000-250-G* **
200	219.1	303	385	2.6	200000-250-G* **

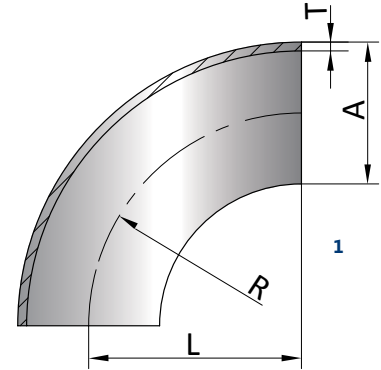

* The first referse to material guide, according to Table
** The last digit referse to surface quality, according to Table 2

Table1

Material Guide	
1.4301 (304)	3
1.4307 (304L)	4
1.4401 (316)	5
1.4404 (316L)	6

Table 2

Inside Surface	Outside Surface	Ordering Code
No finish requirement	No finish requirement	u
MP* 30μ-in 0.80μm	No finish requirement	0
MP* 30μ-in 0.80μm	MP* 30μ-in 0.80μm	3
MP* 20μ-in 0.51μm	MP* 30μ-in 0.80μm	4
MP* 12μ-in 0.30μm	MP* 30μ-in 0.80μm	7
MP* 9μ-in 0.23μm	MP* 30μ-in 0.80μm	8
Mirror	MP* 30μ-in 0.80μm	9

*MP: Mechanically Polished

Ordering Example

Description	Nomimal Size DN	Ordering Code
Type 250	25	025000-250-G64

*Material and Surface are including to the ordering code